

FLOOR PLAN

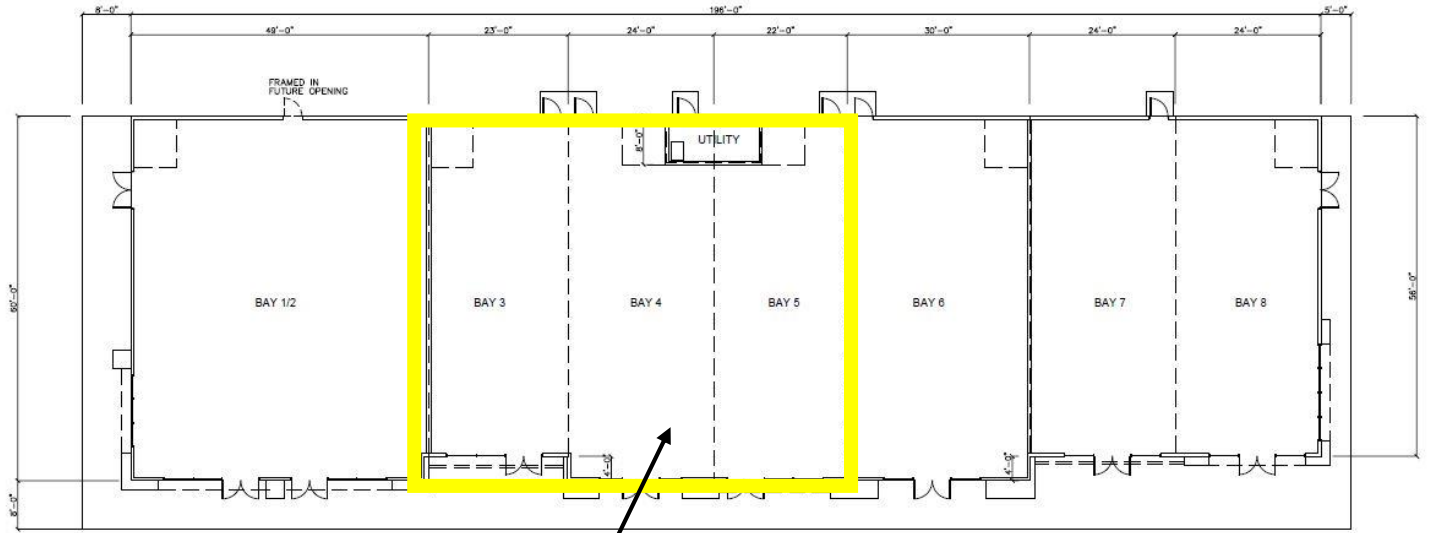

PROPOSED FLOOR PLAN

Available bays

DESIGN NOTES	
BUILDING AREA	
C.R.U. 5	= 11,475 SQ. FT.
FLOOR AREAS	
BAY 1/2	= 2,937 SQ. FT.
BAY 3	= 1,288 SQ. FT.
BAY 4	= 1,381 SQ. FT.
BAY 5	= 1,260 SQ. FT.
BAY 6	= 1,801 SQ. FT.
BAY 7	= 1,344 SQ. FT.
BAY 8	= 1,344 SQ. FT.
UTILITY	= 120 SQ. FT.